

Product Datasheet

STO-30

T-piece Open

The STO-30 is an open T-piece for cable protection conduits with an outer diameter of 30 mm. This T-piece allows for a right-angle branch from a continuous conduit, enabling efficient distribution or routing of cables within industrial installations.

Thanks to the integrated connection system, no separate coupling sleeve is required for installation.

Technical specifications

Type:	Open T-piece
For conduit diameter:	30 mm
Compatible with:	SR-30 and SRL-30 cable protection tubes
Inner diameter:	30 mm
Wall thickness:	1.5 mm
Mounting:	Integrated connection
Weight:	0.66 – 0.70 kg/unit

Available variants

Hot-dip galvanized steel (SR-30-FT)

For standard industrial applications

Material:	Cold-rolled structural steel S235JRG
Finish:	Hot-dip galvanized according to NEN-EN-ISO 1461 (min. 45 µm)

Stainless steel 304 (SR-30-ER2)

For enhanced corrosion resistance

Material:	Stainless steel 304 (ER2)
Finish:	Pickled and passivated

Stainless steel 316L (SR-30-ER4)

For highly corrosive environments

Material:	Stainless steel 316L (1.4404)
Finish:	Pickled and passivated

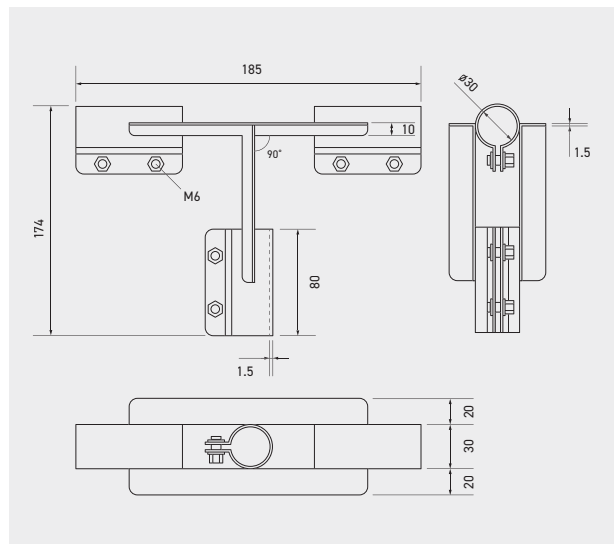
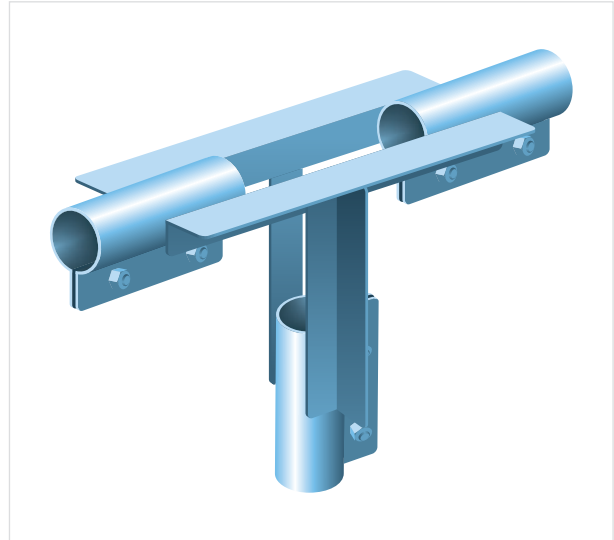

Toepassing

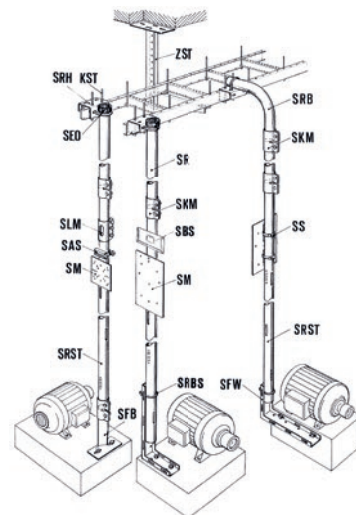

Article number	D mm	E mm	kg/unit
STO-30-FT	30	1.5	0.70
STO-30-ER2	30	1.5	0.66
STO-30-ER4	30	1.5	0.66